

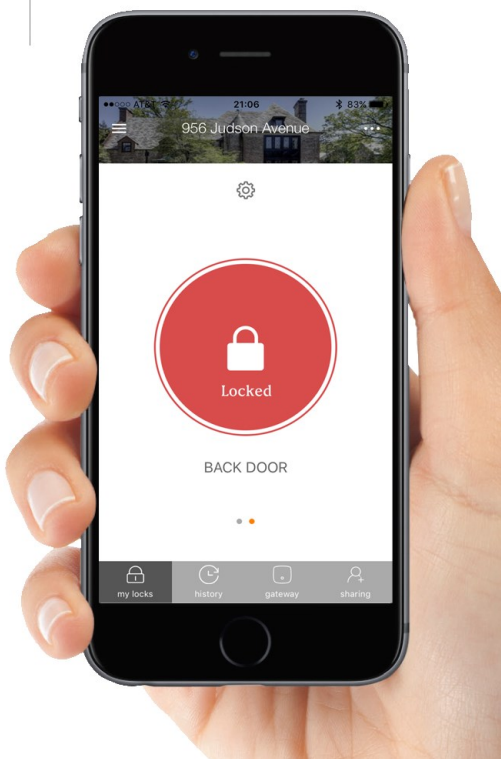

Smart Keypad Deadbolt

Let's get started!



Need help? We're here for you.

Visit us online at www.lark-wi.com/support

Email us at support@lark-wi.com

www.lark-wi.com/support

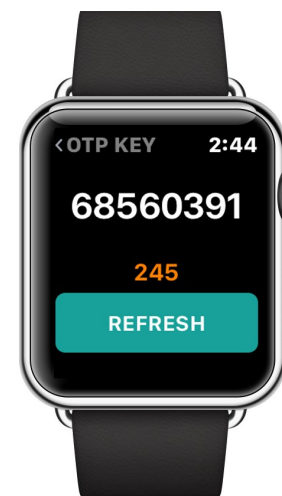
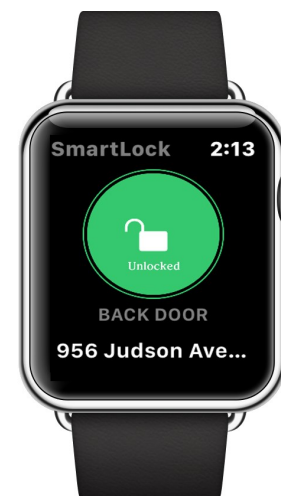

What's in the box



Keys



Deadbolt latch

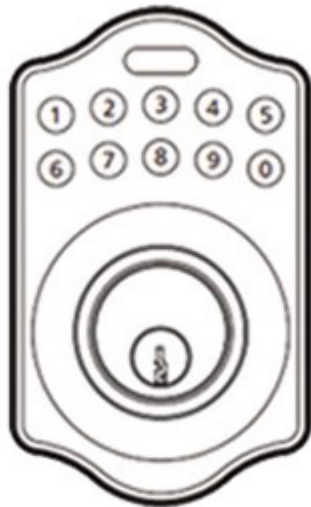

Deadbolt Keypad



Interior



What you'll need...



Lark-Wi is designed to use wireless to communicate with your phone. Your phone will then communicate with the server using the cellular or data connection on the device. Your authorized smart phone will need to have internet connection - either wireless or cellular data - to operate the lock.

Lark-Wi does require an internet connection for initial Lark-Wi setup (with the mobile app), Create an account or account login, add smart lock and firmware update.



Mobile Device

iOS 9 (or greater) Apple iPhone® : iPhone 4s, 5, 5s, 6, 6 Plus, 6s, 6s Plus, 7,8,x.

Android:

Compatible with many Android phones running Android 5.0 or greater.



Four AA 1.5v alkaline batteries, we recommend the 4 x lithium 1.5 V battery.

Easy Install

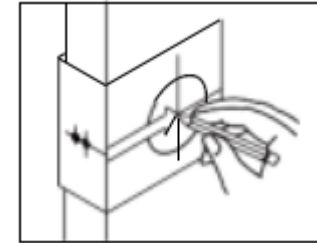
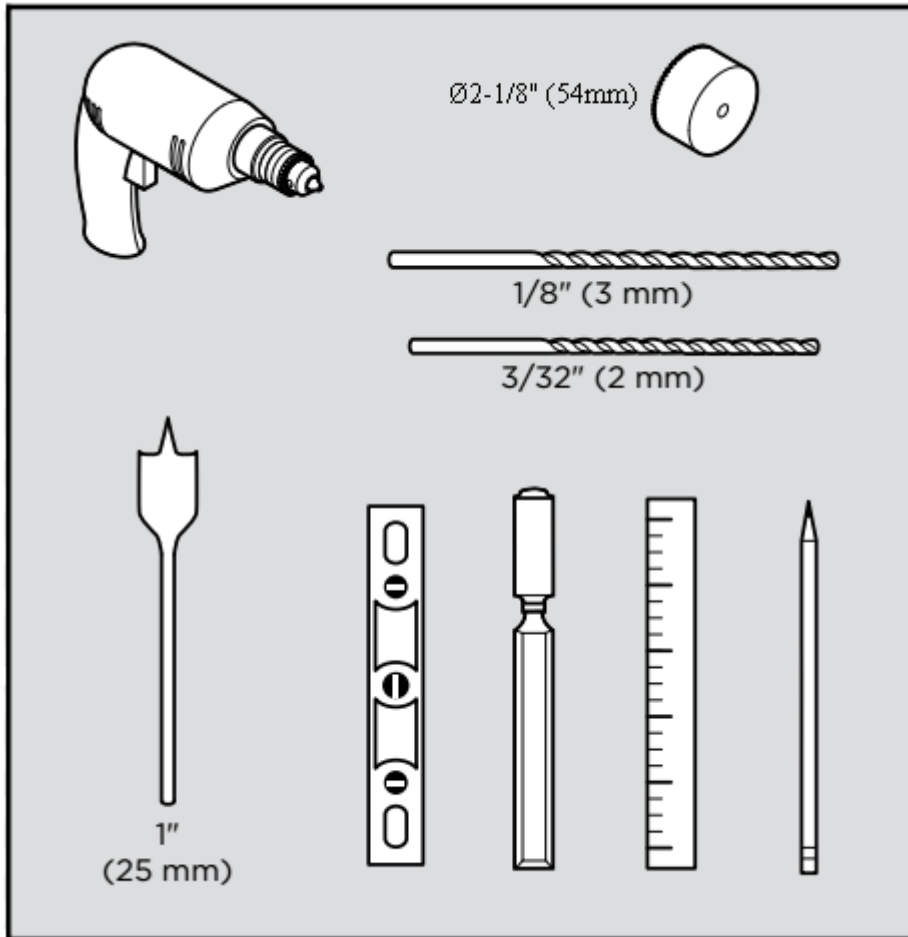

1 Mark The Door With Template

Select the height and backset as desired on the door face ; use the TEMPLATE as an indication to mark the center of the circle on the door face and the center of the door edge.

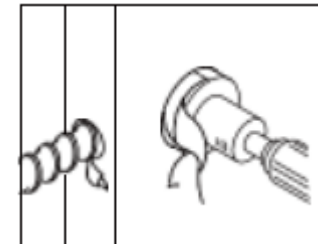

2 Drill Holes

Using the marks as a guide to drill a hole $\text{Ø}2\text{-}1/8"$ (54mm) through the door face for the lockset, then a hole of $\text{Ø}1"$ (25.4mm) for latch .

Easy Install

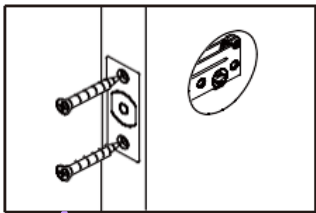
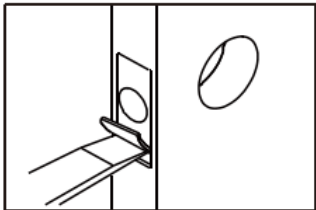
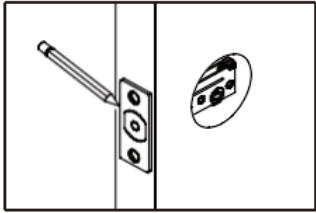

3 Install Latch

a) Insert the latch and ensure it is paralleled to the door face.

Mark the outline of the faceplate, then take out the latch.

b) Chisel 1/8" (3mm) deep along the outline to allow the faceplate to be aligned with the door edge.

c) Insert the latch and tighten it with screws.

Note : please use tapping screws for metal door.

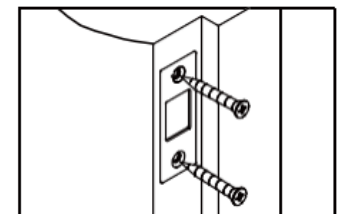
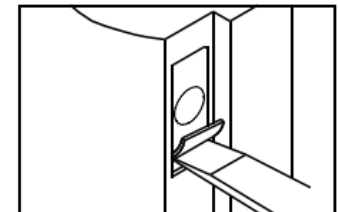
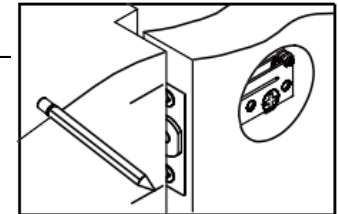

4 Install Strike

a) To identify the center of strike :

close the door, on the basis of the faceplate mark horizontal center line of strike.

Ensure the center of faceplate and the center of strike are aligned.

b) Use the mark as a guide outlines the strike.

Chisel 5/64" (2mm) deep along the strike outline to allow the strike to be aligned with the doorframe.

c) Insert the strike and tighten it with screws.

Note : please use "tapping screws" for metal door.

Easy Install

5 Install Keypad Assembly

- Ensure the latch bolt must be retracted.
- Please refer to the diagram below for Cylinder Installation. Place deadbolt against keypad with tailpiece in horizontal position inserted through hub of the latch.
- Pass the IC wire under the latch to the interior side of the door.

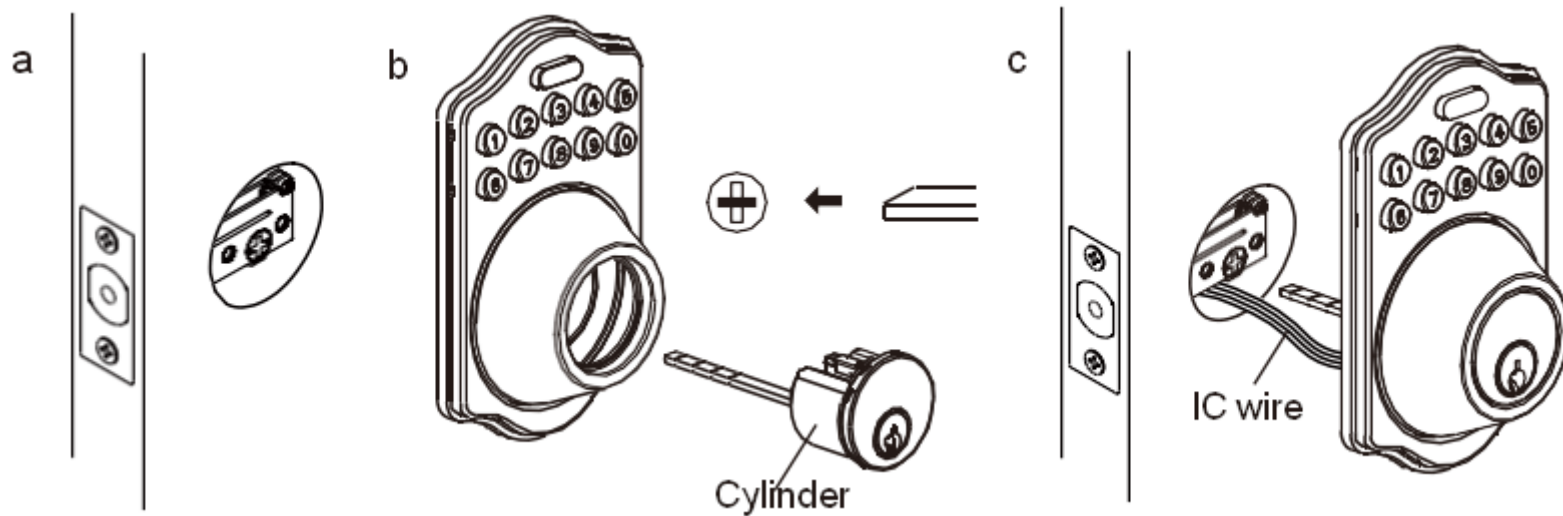

Easy Install

6 Install Inside Mounting Plate

Pass the IC wire through the wire hole of the mounting plate.

Fix the mounting plate with screws.

If outside lock assembly is lopsided, please loosen the screws to adjust it's position and tighten the screws again.

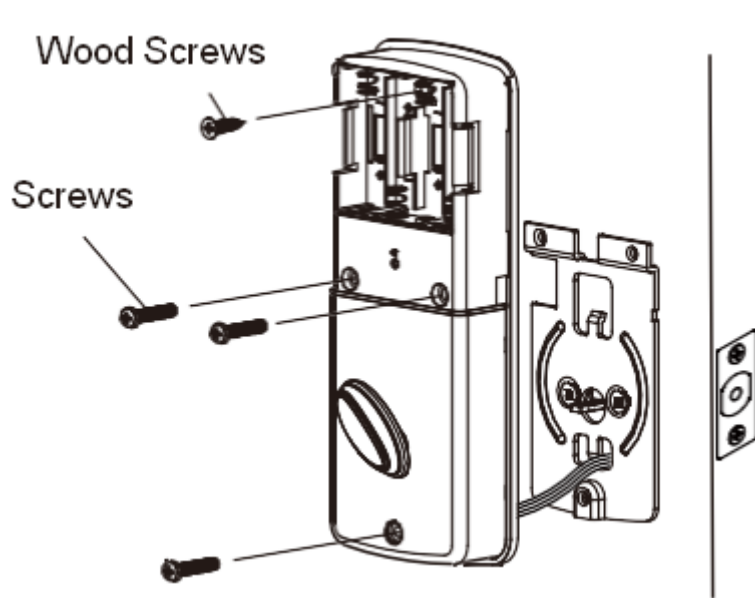
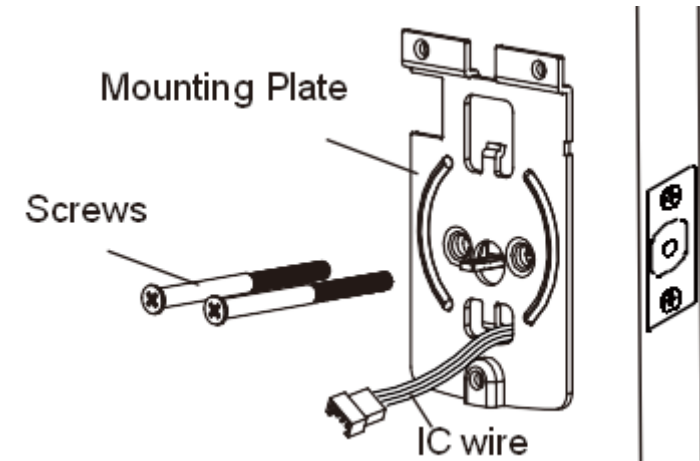

7 Install receiver module

Connect the IC wire and ensure the tailpiece is engaged with turn piece, then attach receiver module to the door with screws.

It's optional to use wood screws. (Wood screws only for wood door)

Prepare

8

Adjusting Turn Piece

Turn the turn piece to left for 45 degrees when it's right-handed door.
Turn the turn piece to right for 45 degrees when it's left handed door.

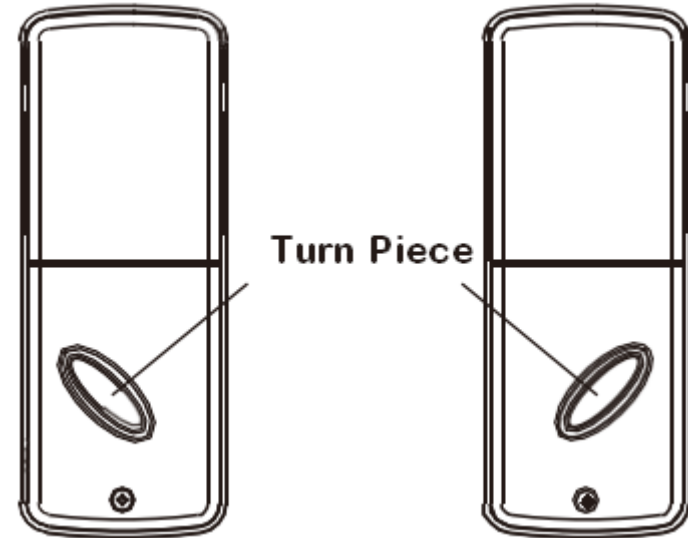
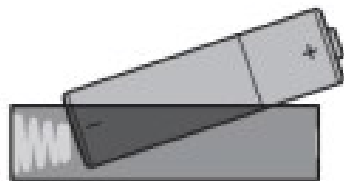
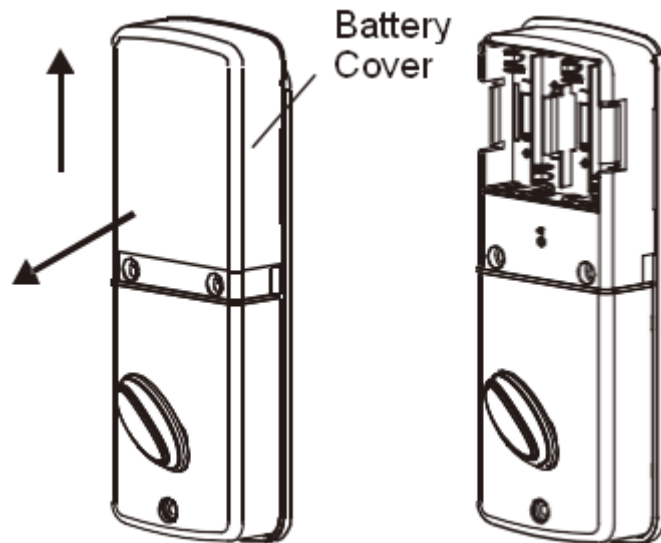

9

Batteries Installation

Remove the battery cover (push it up and pull it out).

Insert 4 (AA) 1.5V alkaline batteries and put the battery cover back to the receiver module.

Prepare

Download the Lark-Wi app.

Download the lark-wi app from apple store :

Search Apple Store, used Keywords: **Lark-Wi** , Then select: **Lark-Wi**

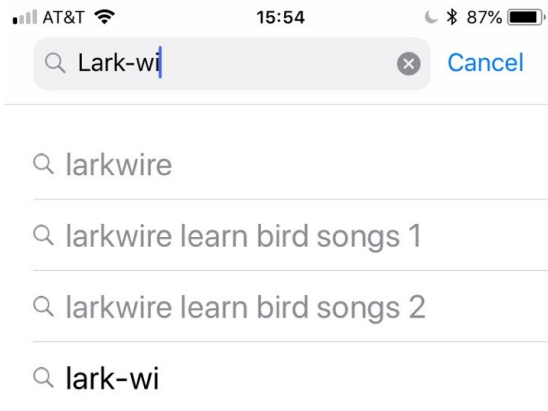

When using your smartphone to lock and unlock the door, make sure the smartphone is on, **Bluetooth is enabled**, and the Lark-Wi app is running.

Your authorized smart phone will need to **have internet connection** - either wireless or cellular data - to operate the lock.

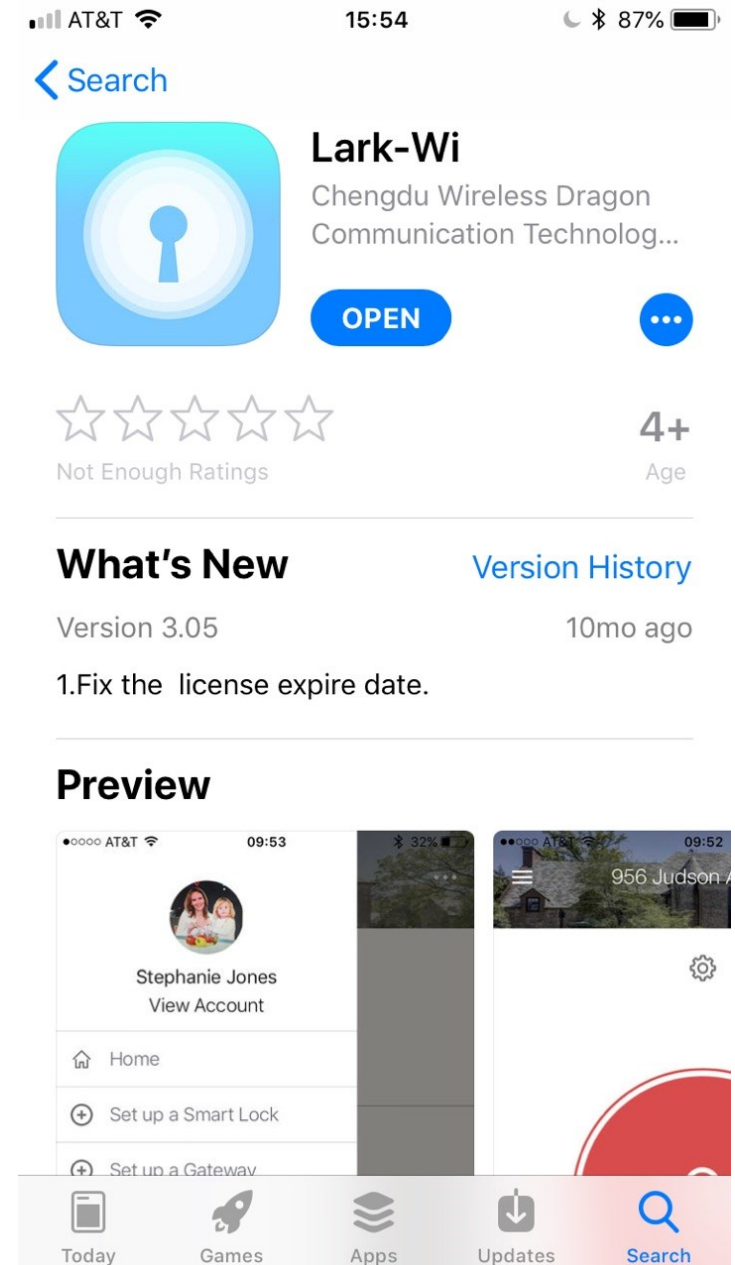
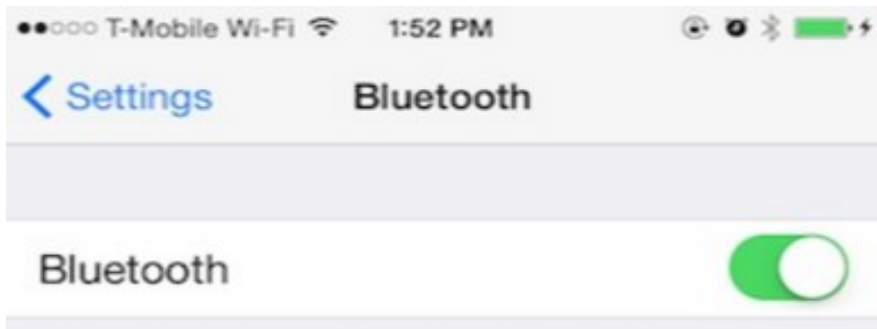

Create an Account

Follow the instructions inside the app to create an account, enroll register with your smartphone first .

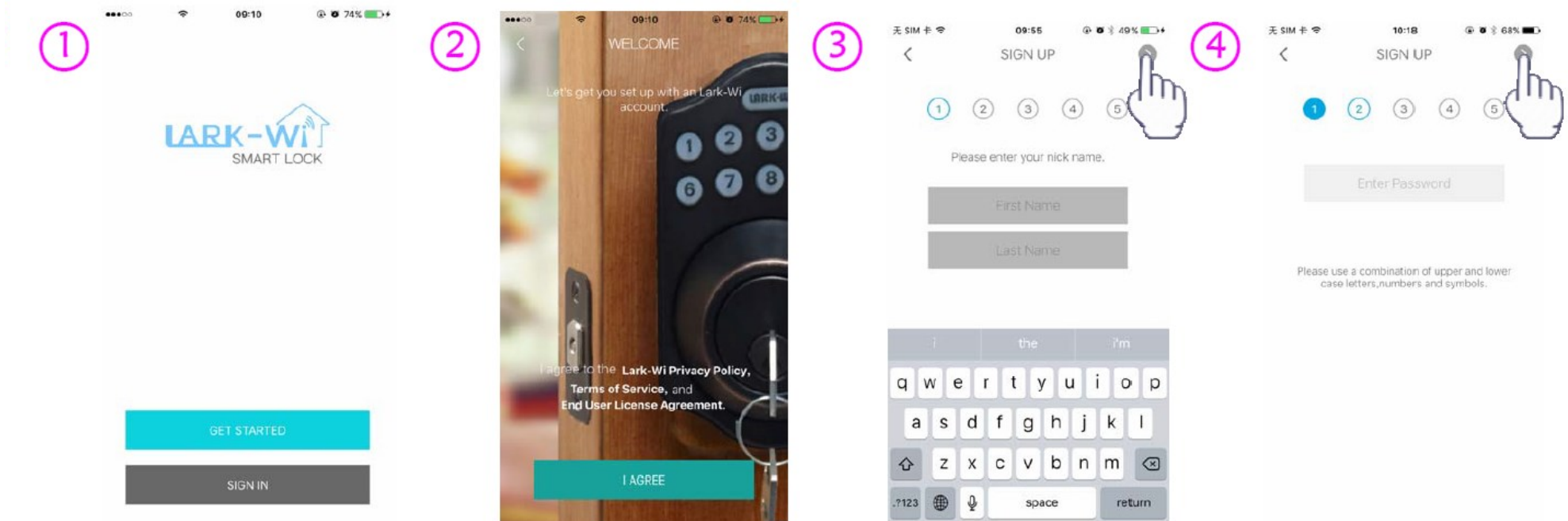

- 1、 Open the Lark-Wi app, Select **GET STARTING** .
- 2、 You can read the Lark-Wi Privacy Policy, Terms of Service and End User License Agreement by tapping the link at the bottom of the screen. When you are ready to continue, tap **I Agree**.
- 3、 Enter Your First Name, Last Name.
- 4、 Lark-Wi requires your password to be at least 8 characters long .

Create an Account use e-mail (Step 5-8)

Follow the instructions inside the app to create an account, enroll register with your smartphone first .

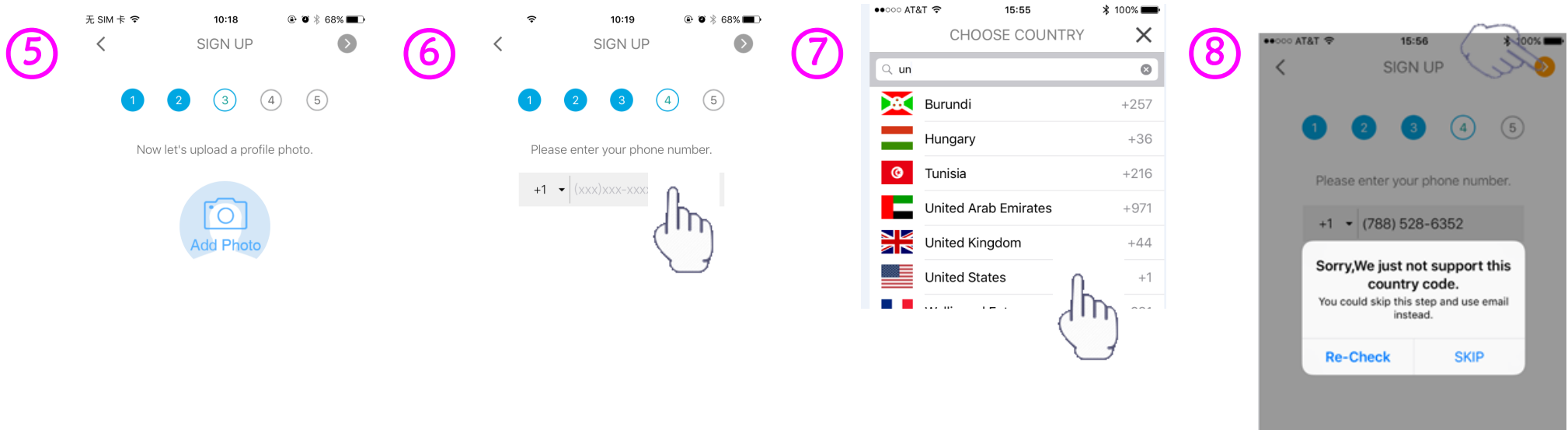

WHY DO I HAVE TO UPLOAD A PHOTO

5. Take a profile photo or upload one from your phone. Profile photos help Lark-Wi users verify each others' identities when inviting and managing access.
6. Select the phone number for your country.
7. For example, you can search for a US mobile phone code of 1
8. If you see a prompt that your region does not support SMS authentication, you only need to use e-mail to register your account, then you can choose skip

Create an Account use e-mail (Step 9-12)

Follow the instructions inside the app to create an account, enroll register with your smartphone first .

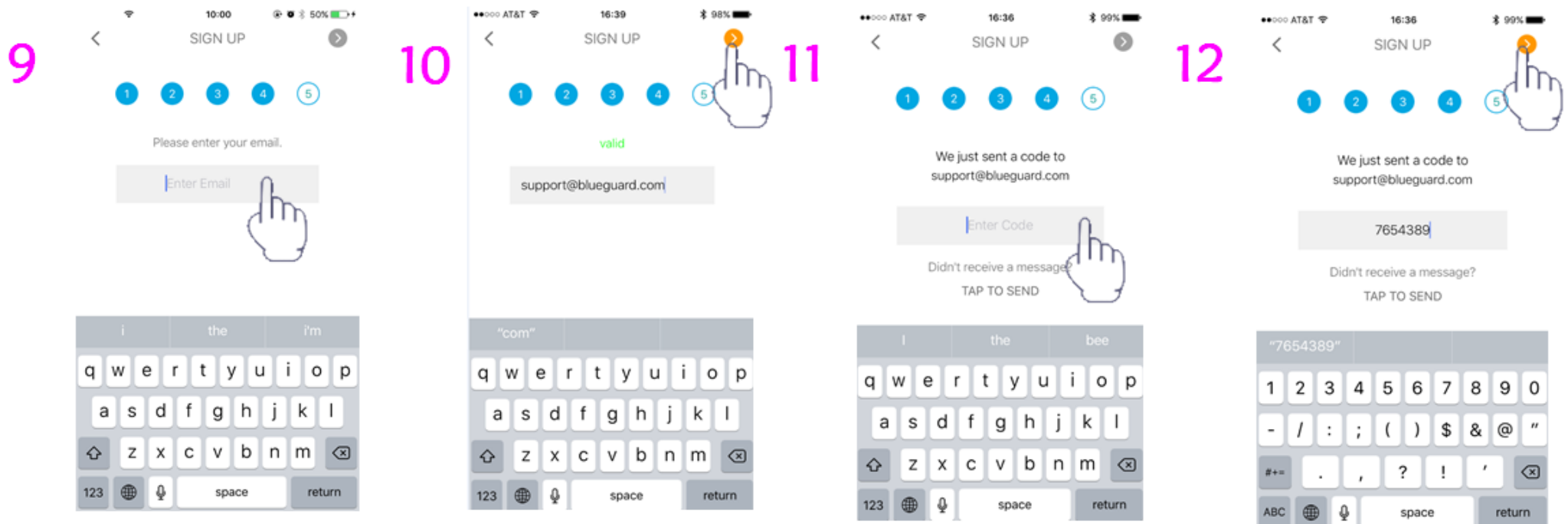

9. Enter the email address you'd like to use for your account. Again, it's important to use your real email address.

10. Enter the e-mail, click Next, we will send a verification code to the input of your mailbox, you may need to wait a few minutes, your mailbox will receive the 6-bit verification code;

11. Please enter your verification code and you get it from your mailbox

12. Click Next, you complete your account registration

Set up a lock Step 1

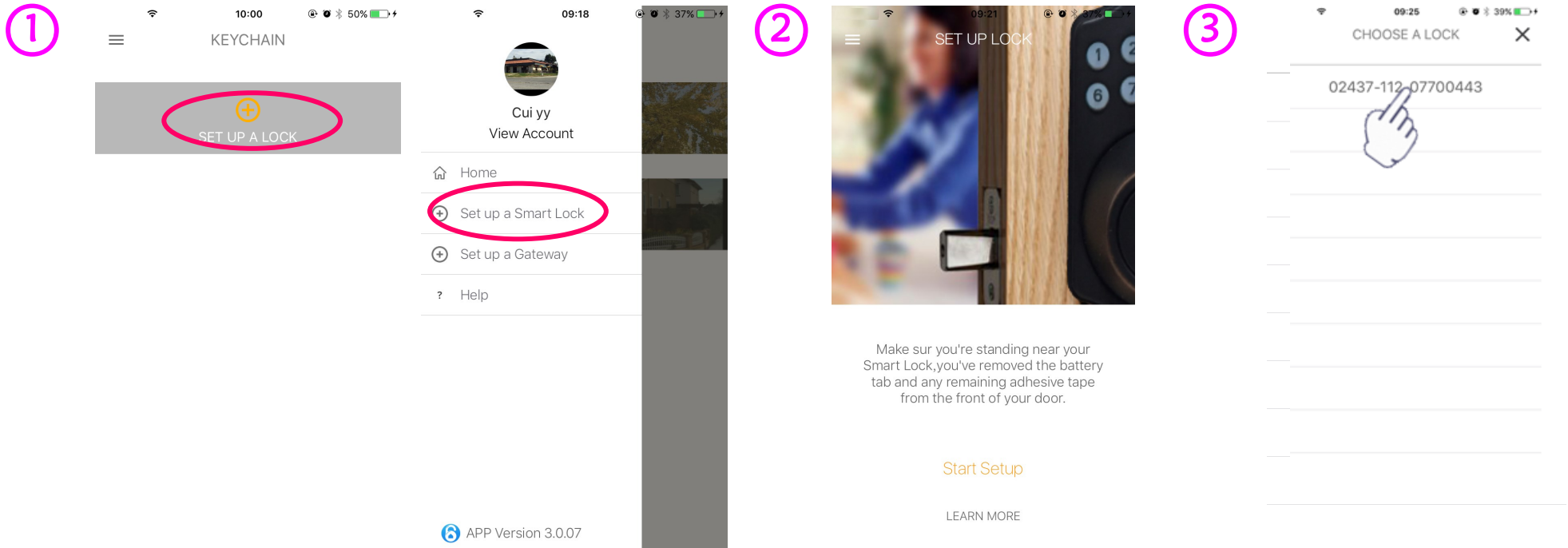

1、 **Make sure your smart lock is in the reset state, or you just reset your smart lock** , than Tap Set Up a Lock.

2、 Read the Instructions and Tap Start Setup. The Lark-Wi App Will Begin Scanning For Your Lock.

If no locks found:

- Confirm that the battery has been installed.
- Make sure you're standing in front of the lock.
- Confirm that Bluetooth is enabled on your phone.

Reset - Press for more than 15 seconds and hear the music.

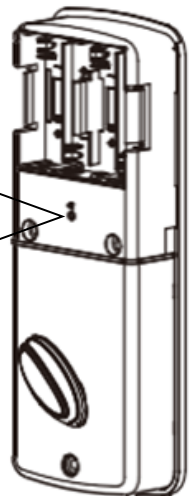

Note: If your Smart Lock uses less than the 2.8 version of APP, you will need to follow the instructions to update the firmware

Set up a lock Step 2

4. Choose a Name for Your Lock.
5. You Can Add the Lock to an Existing House, or Add a New House.
6. The App is Scanning For Your Lock, tap continue.

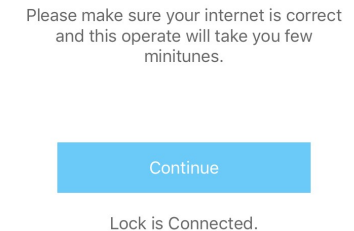
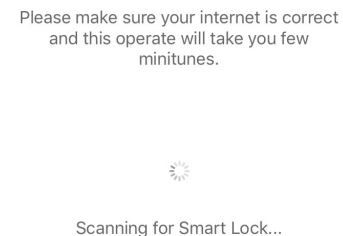
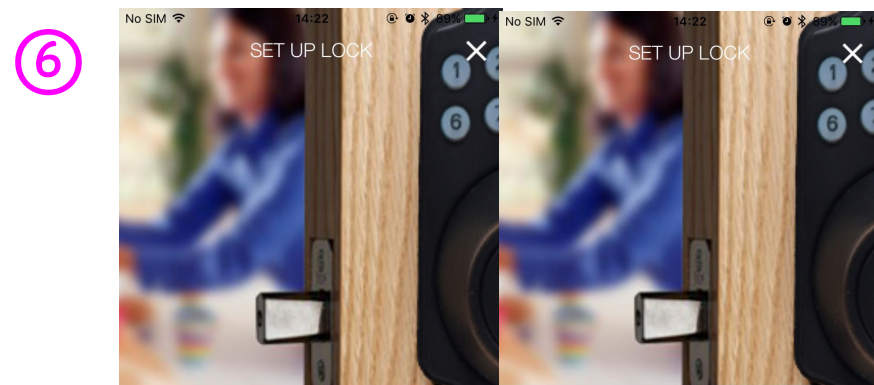
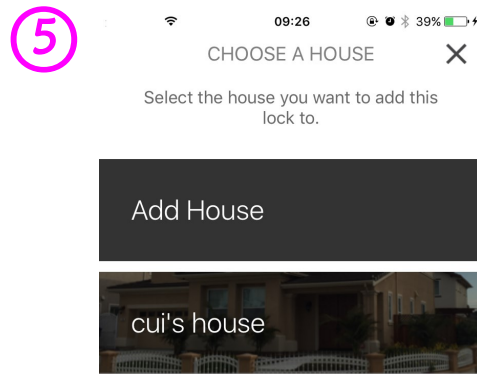
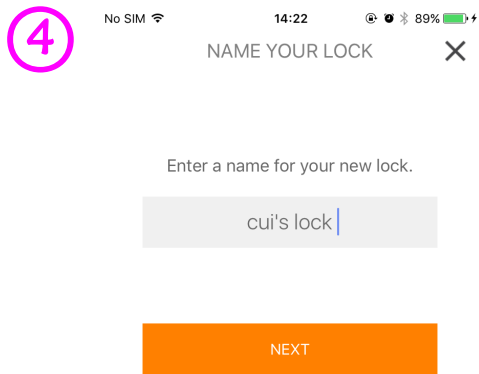
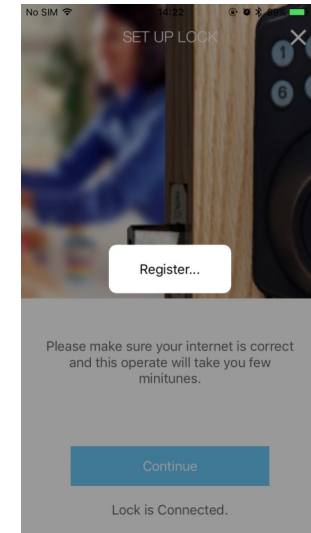

Set up a lock Step 3

7. Beginning the Calibration Process. Follow the Onscreen Instructions

Rotate Your Lock to **Unlock**.

8. tap continue.

9. Tap the Green Circle to Test Your Lock, Your Lock is Ready to Use.

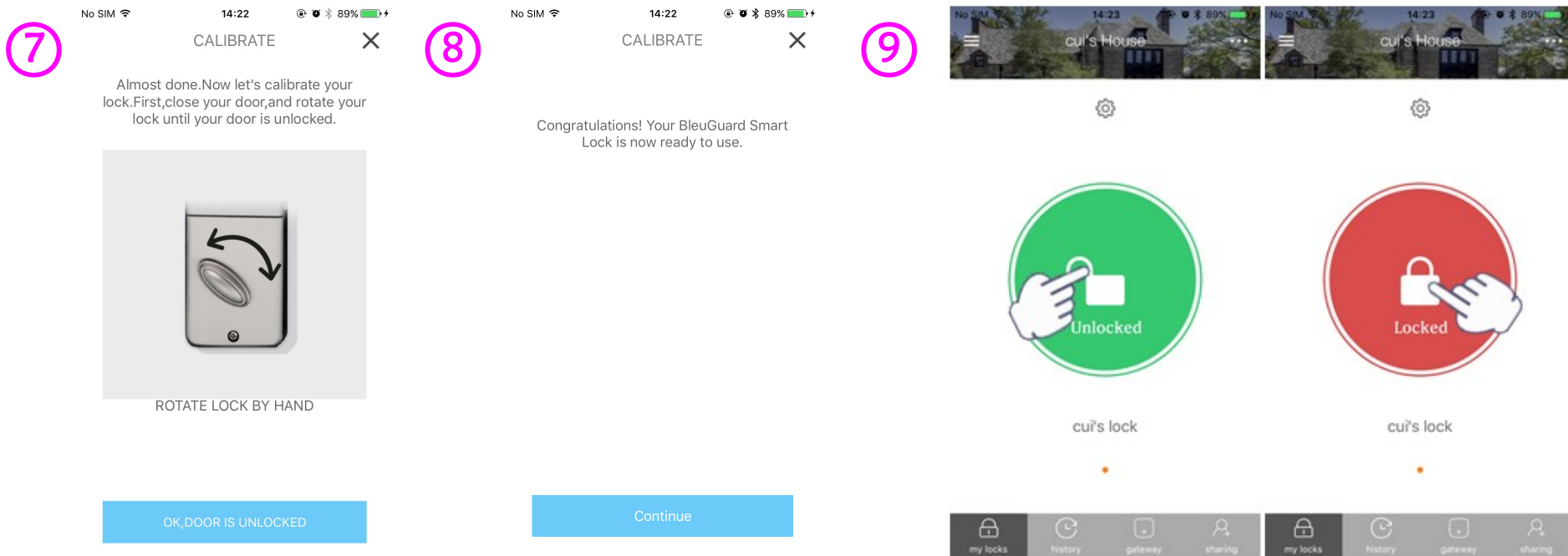

Control My Lock With Lark-Wi App

The Lark-Wi Smart Lock is simple to use. Approach your door and open the Lark-Wi app in your smartphone.

The red circle indicates that your door is locked. Tap the red circle to unlock your door.

The green circle indicates that your door is unlocked. Tap the green circle to lock your door.

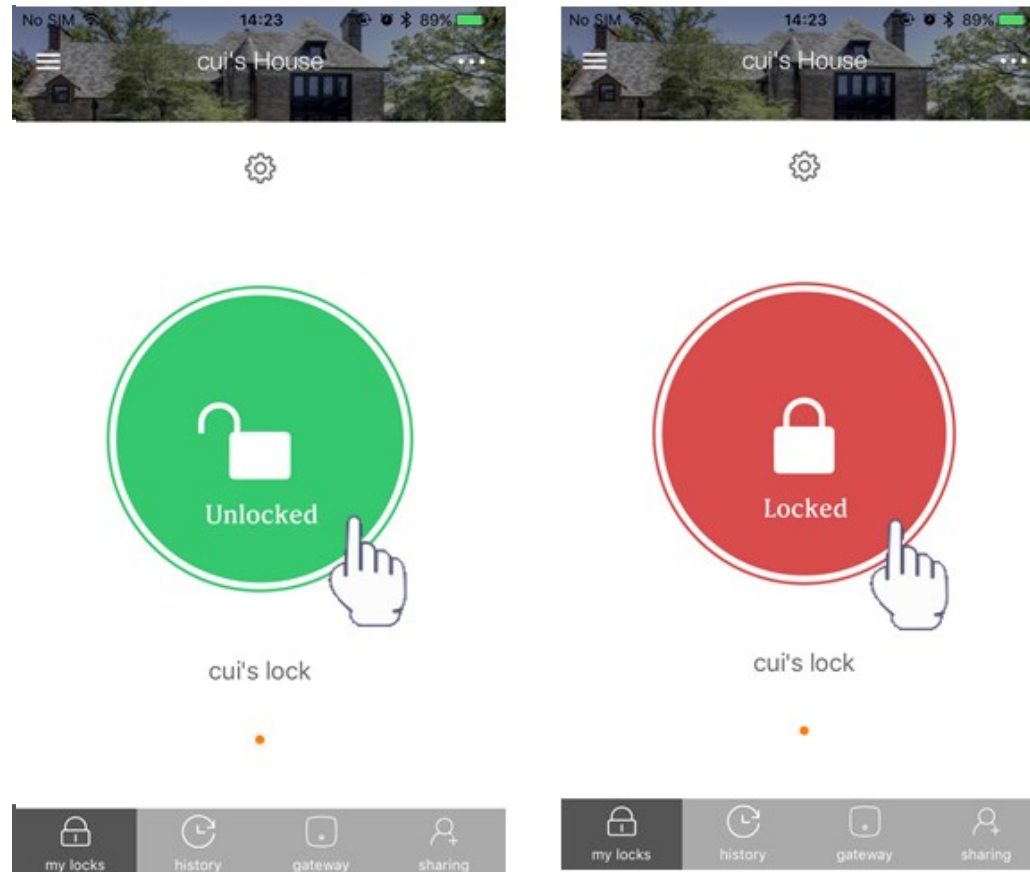

To activate this feature you must be in range of your lock.

Activity Feed

If you are an owner of an Lark-Wi Smart Lock, you'll notice an “history” tab in the Home area of the Lark-Wi app. This opens the Lark-Wi Activity Feed screen. The Activity Feed shows all of the Lark-Wi Activity events in your house, with the most recent event showing at the top.

All events in your feed are connected with a continuous light gray line. Sometimes events at your door are related to each other. When these collections of events occur at the same door with the same user in the same time span, we call them “stories” and connect them with a thicker, darker gray line.

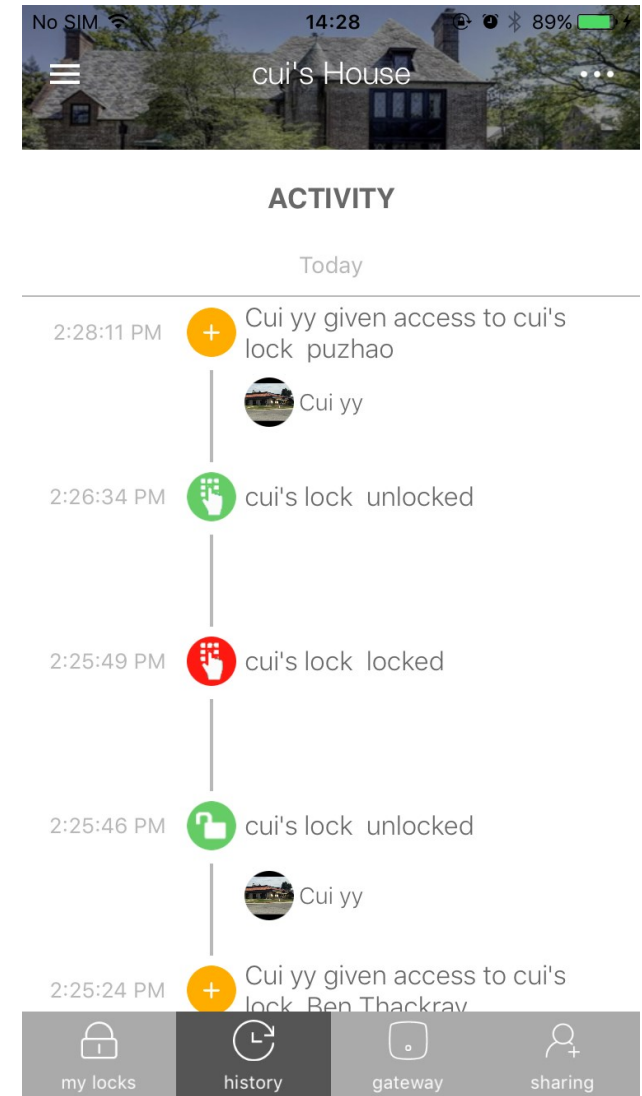

Lock Settings

Tap the Setting Gear Icon Above the Lock Circle.

In the Lock Settings:

Change My Lock Name.

Enable/Disable Lock Sounds.

Enable Auto-Lock .

Find My Lock's Serial Number.

Delete My Lock.

Calibration.

Updating Lock Firmware.

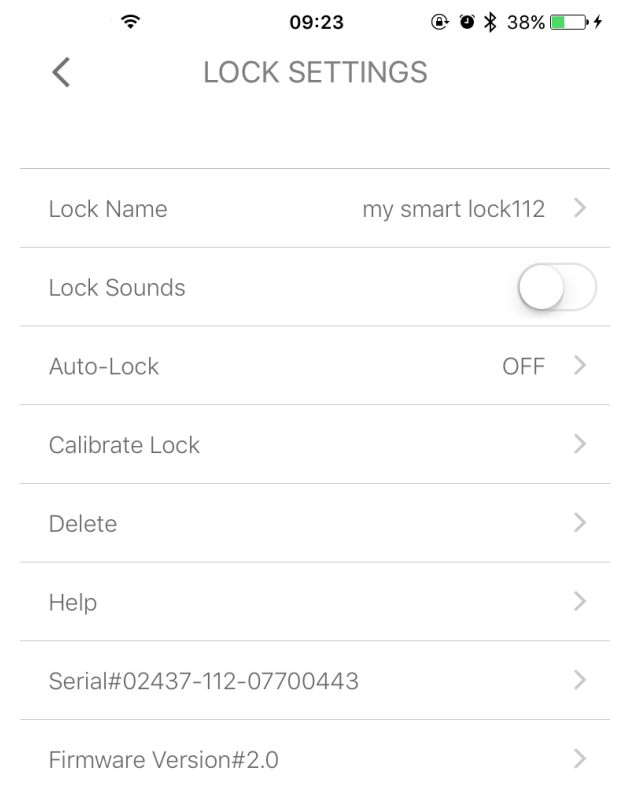
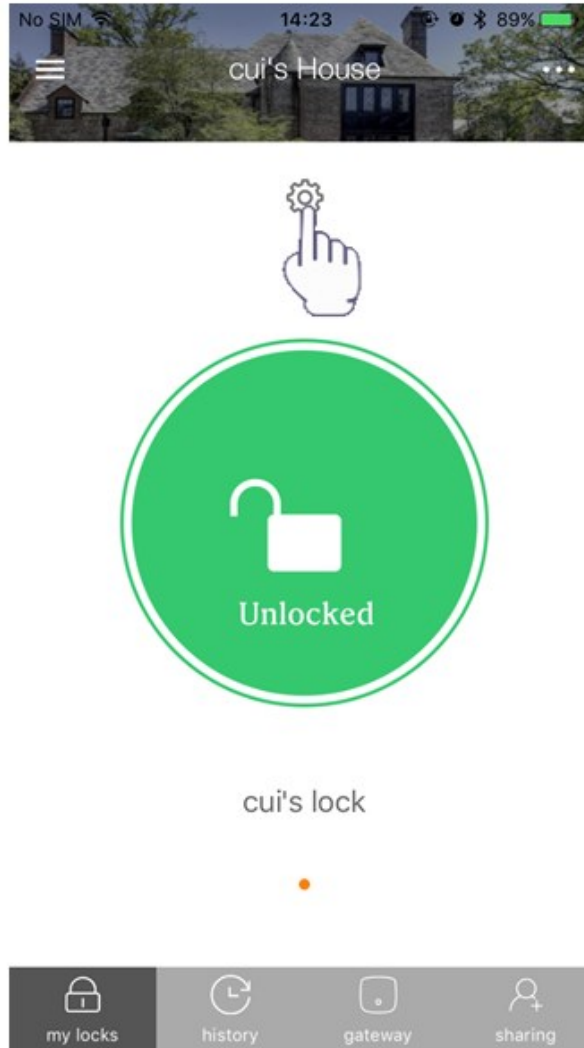

Send an invite

With Lark-Wi Smart Lock you can choose family, friends, or services from your contacts and issue them keys in seconds. Simply send each guest an invitation to download the app. After doing so, they will have instant access to your home based on the access levels you set.

To add a guest you will first need to send them an invite. Please note that invitations to guests will only work if the guest has a compatible smart phone.

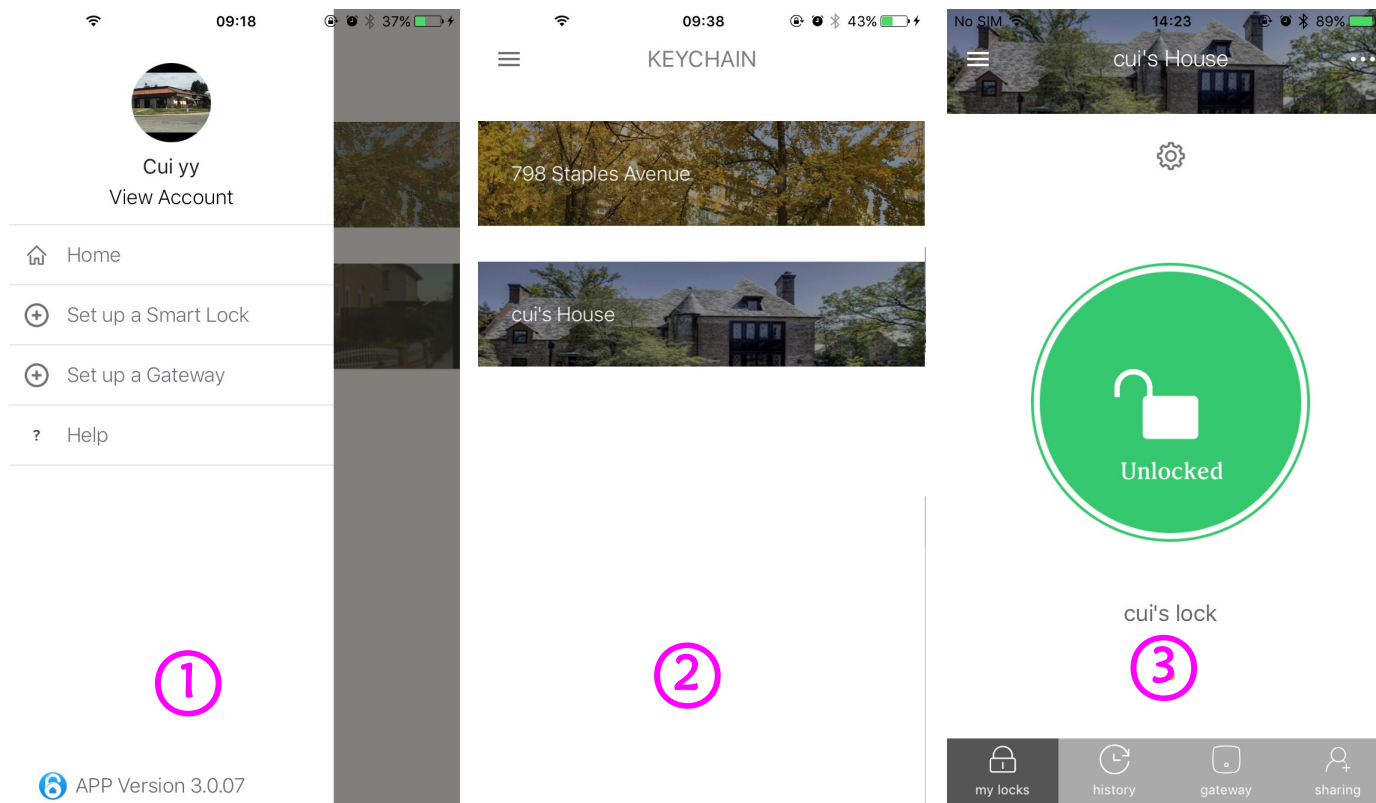

1) Tap Home.

2) Select a house.

3) Select a lock.

Send an invite 2

- 4、 Select the sharing Icon on the lower right. Select Invite to add a guest.
- 5、 Invite Your Guest By Entering Their Phone Number, or Their Email, or Selecting Them From Your Contact List.
- 6、 Press Send Invite after selecting your invite option.
- 7、 Your guest will now be listed in your Guest List. They will see your lock in their home.

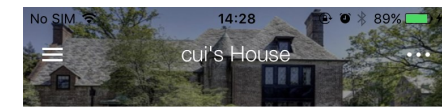
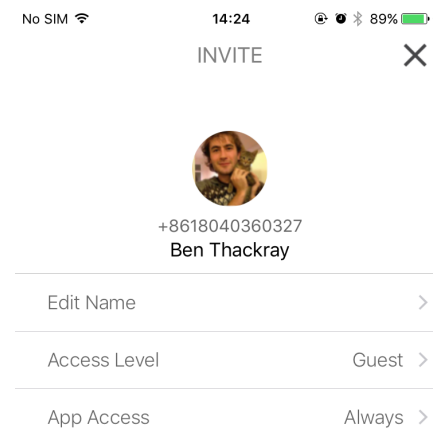
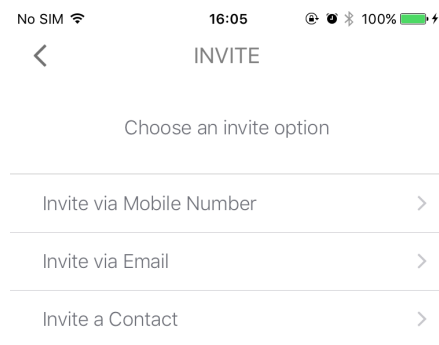
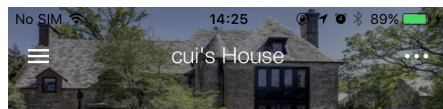

The access levels

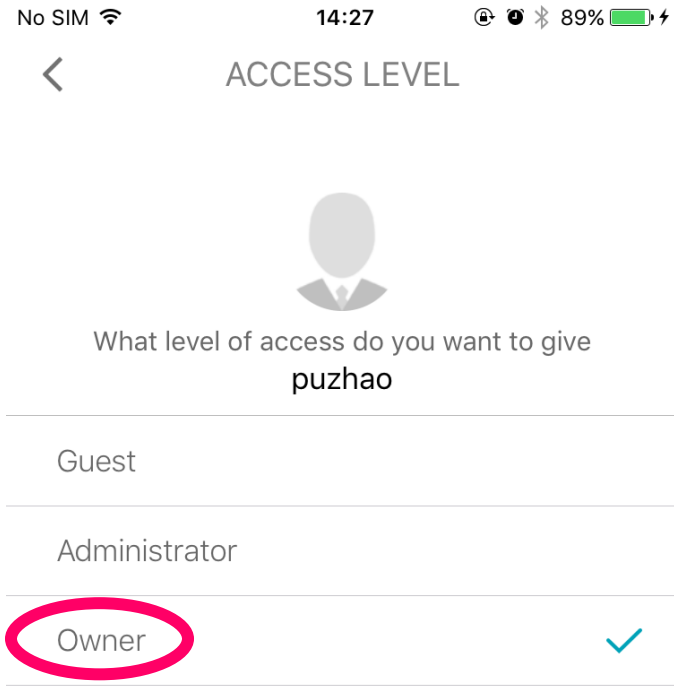

- Can lock and unlock door via Blueguard app
- Can invite/remove guests/administrators/owners
- Can control all lock settings
- Can view activity feed
- Can view guest list

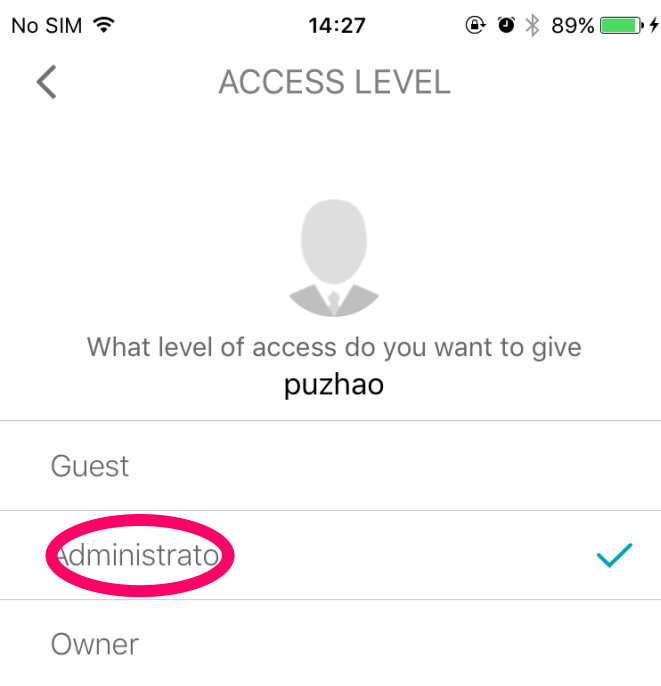

- Can lock and unlock door via Blueguard app
- Can only invite/remove guests
- Can not control all lock settings
- Can view activity feed
- Can view guest list

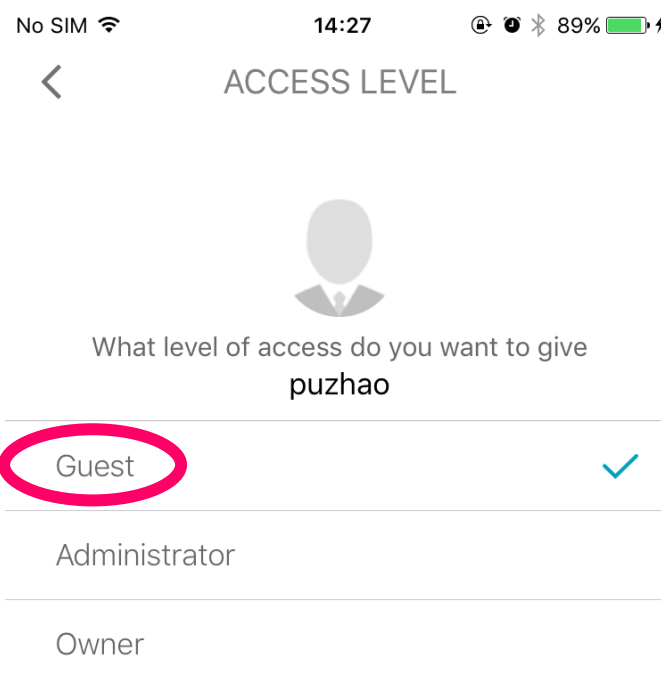

- Can lock and unlock door via Blueguard app
- Can not invite others
- Can not control all lock settings
- Can not view activity feed
- Can not view guest list

Sign Out

- 1、 Tap the Menu Icon on the Upper Left, Select My Account.
- 2、 Tap Sign Out.

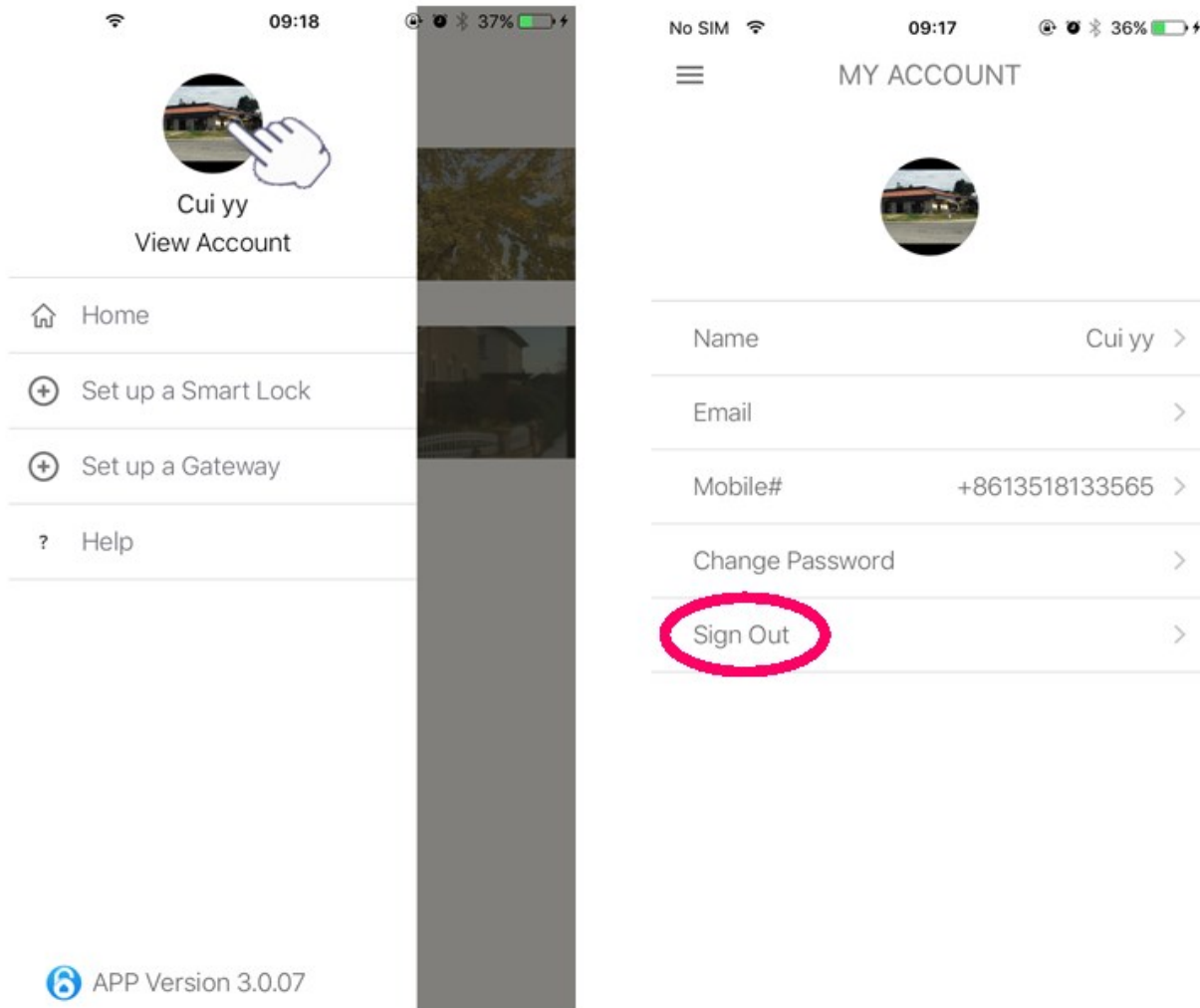

Tips

- 1、 Confirm that Bluetooth **is enabled** on your phone.
- 2、 Your authorized smart phone will need to **have internet connection** - either wireless or cellular data - to operate the lock.

Create an account.

Sign in.

Set up a smart lock.

Send an invite.

View history.

Updating Lock Firmware.

- 3、 Compatible with some Android phones running Android 5.0 or greater.